

PRO-V ACTUATOR WIRING

PART #106180-HAR Rev A

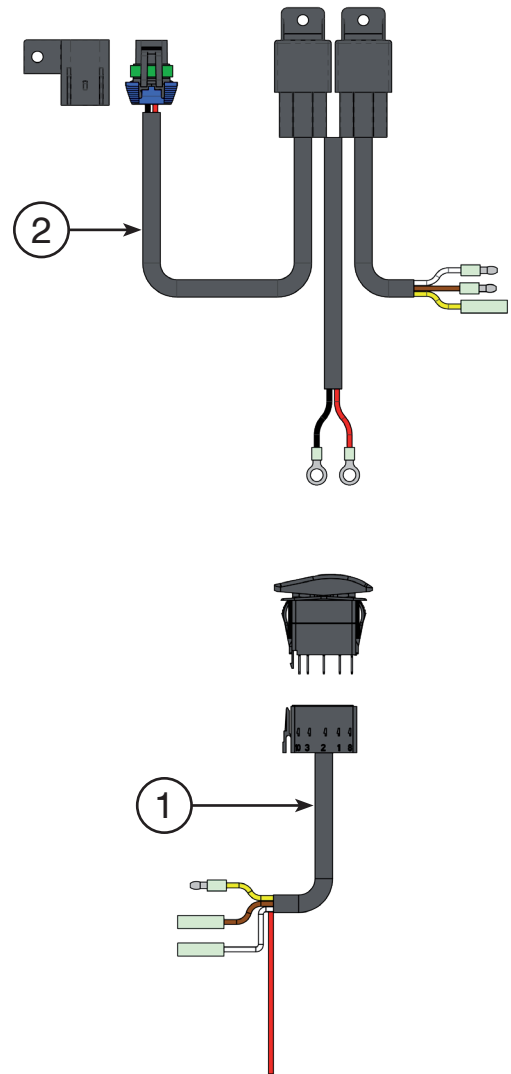
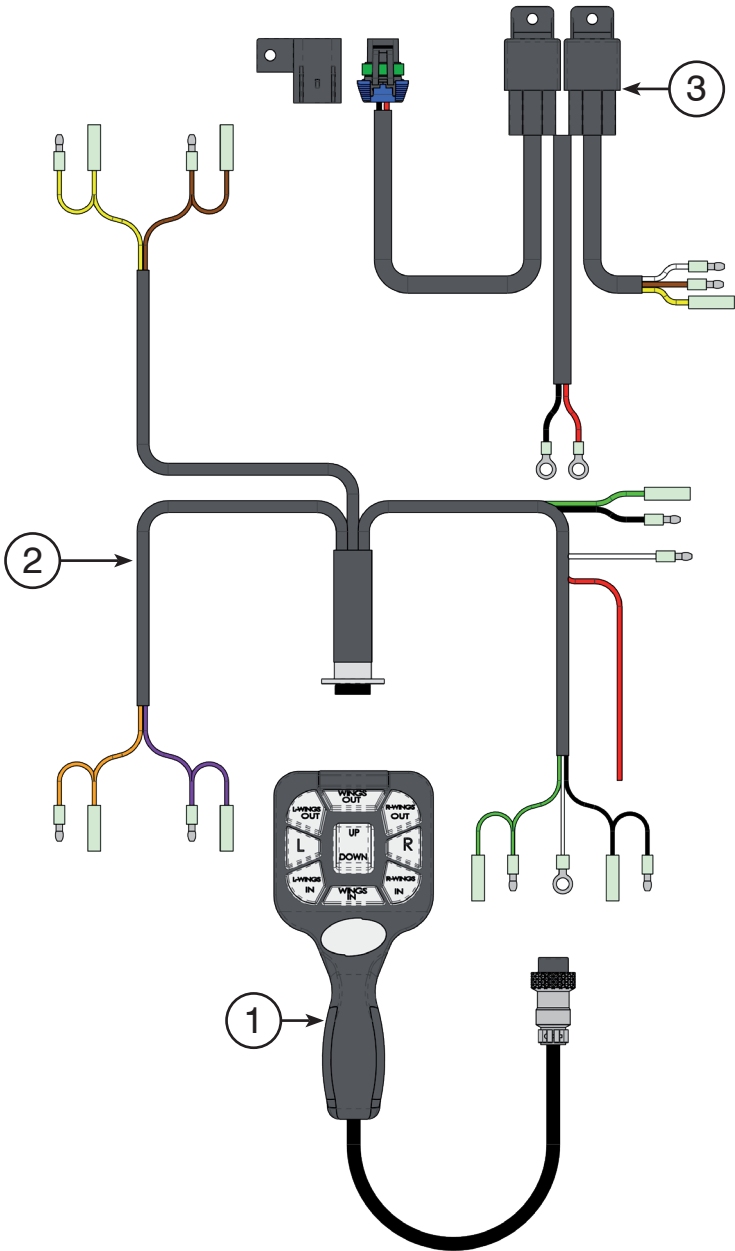

Kit Components 106180-APH		
Item #	Qty.	V-Plow Hand Remote Kit
1	1	(ACT-VHR) Hand Remote
2	1	(ACT-HR-HAR) Hand Remote Harness
3	2	(ACT-HAR) Actuator Harness

Kit Components 106180-AP		
Item #	Qty.	Dash Rocker Switch Kit
1	2	(ACT-BLDRS-K) Dash Rocker Switch
2	2	(ACT-HAR) Actuator Harness



WIRING INSTRUCTIONS 106180-APH

Figure 1

V-Plow Hand Remote Wiring

Note: ACT-HR-HAR has extra connection points for additional switches. Not all of these connections will be used. If you have connections that are not going to be used, You should wrap those ends in electrical tape.

Note: Your winch switch/contactor may have different colors or connections. On the ACT-HR-HAR, green=winch in, black=winch out, white=ground, and red=keyed power

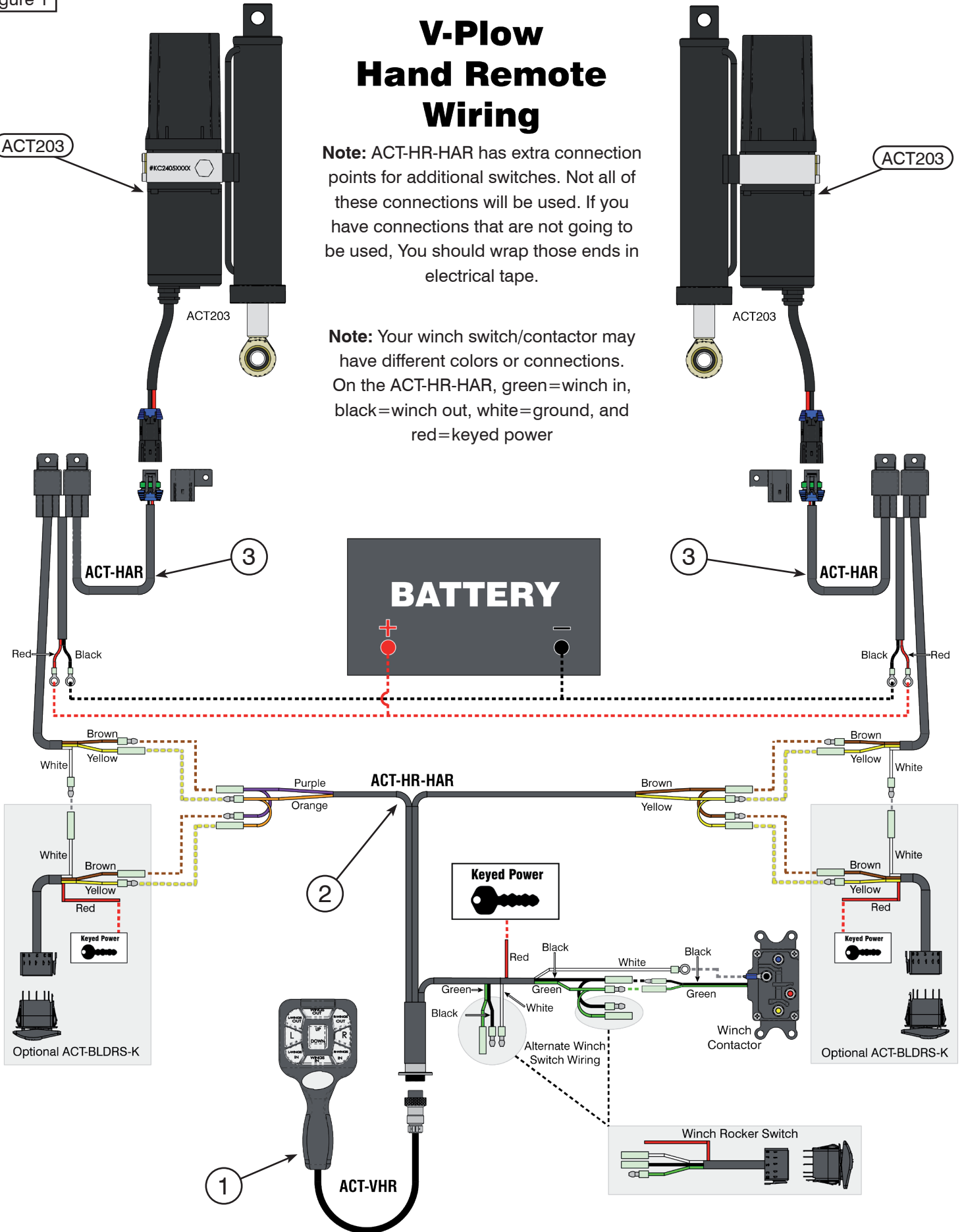

WIRING INSTRUCTIONS 106180-AP

Figure 2

V-Plow Dash Rocker Switch Wiring (x2)

Note: One Side of the V-Plow Actuator Connection is shown below. You will need both installed for proper operation. Driver and passenger sides are identical connections.

