

# KAWASAKI RIDGE

Winch Mount

PART #102225 Rev A

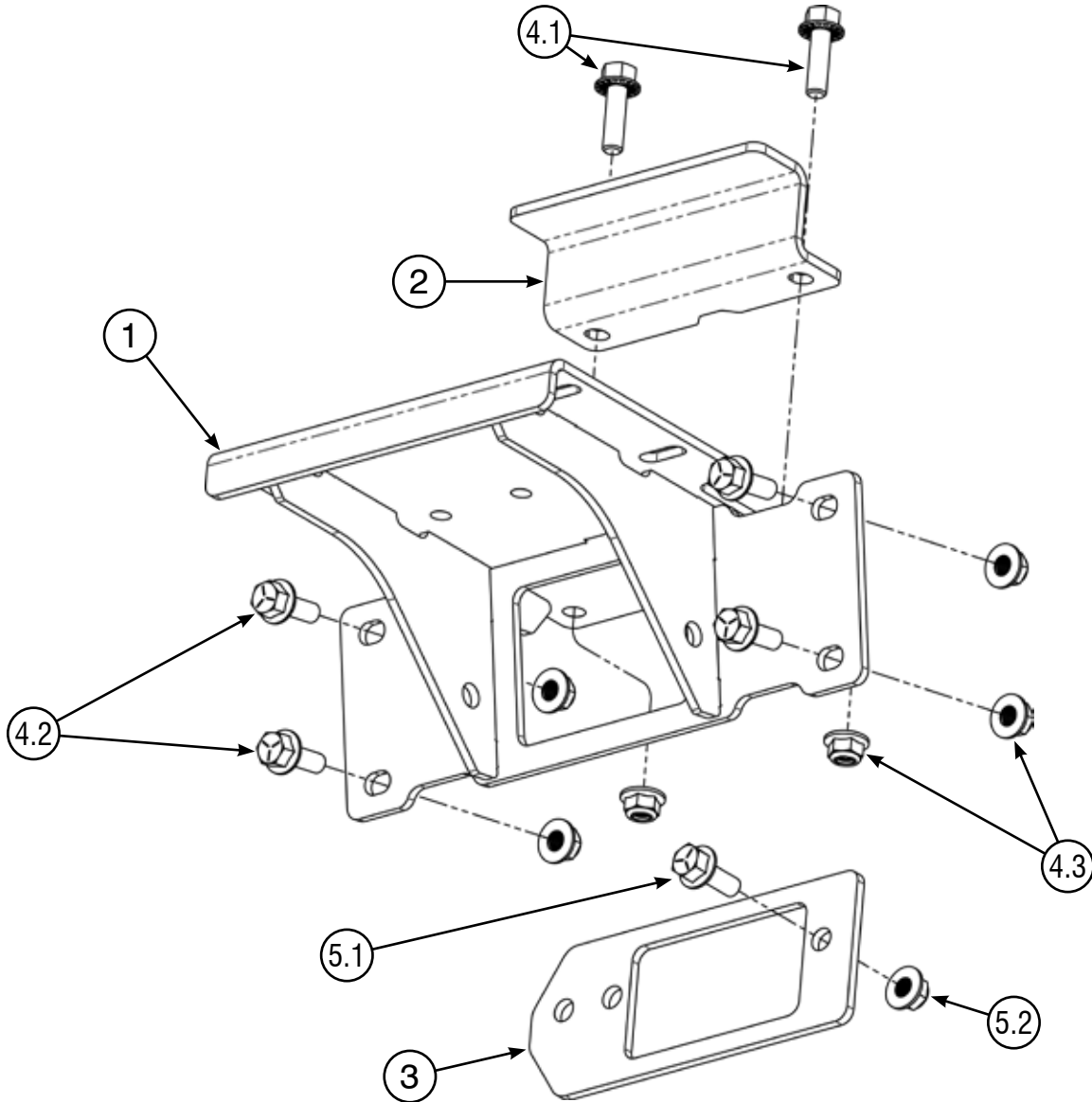

## Kit Components:

Item #	Qty.	Description	Item #	Qty.	Description
1	1	Winch Mount (102226)	4.2	4	3/8"-16 X 1.00" Hex Bolt Flange GR5 Serrated
2	1	Tube Gusset (102224)	4.3	8	3/8"-16 Hex Nut Flange Nylock GR5
3	1	Standard Winch Adaptor Plate (101288)	4.4	6	3/8" Flat Washer *Not Used*
4	1	Hardware Kit HK-413	5	1	Hardware Kit HK-403
4.1	2	3/8"-16 X 1.25" Hex Bolt Flange GR5 Serrated	5.1	1	3/8"-16 X 1.00" Hex Bolt Flange GR5 Serrated
			5.2	1	3/8"-16 Hex Nut Flange Nylock GR5



# INSTALLATION INSTRUCTIONS

## Notice

Torque bolts to ANSI Specs (or OEM specs if applicable), unless otherwise stated. After the first use and at the start of each season, check torque.

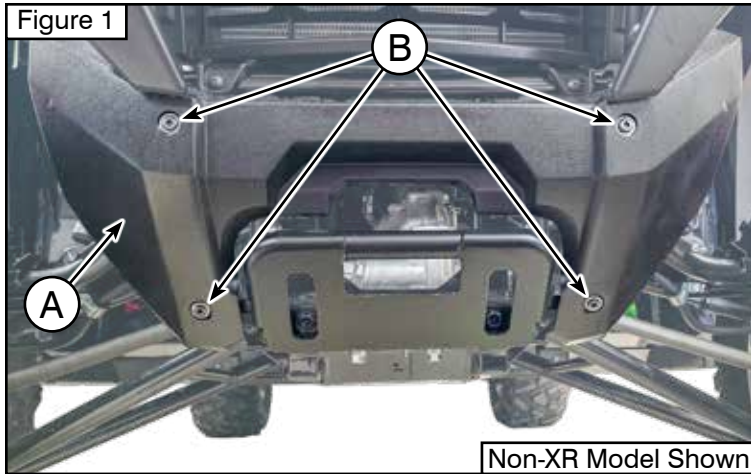

**Note:** Make sure all hardware needed to complete this mount is in the package. Thoroughly read through and understand the instructions before installing.

## Installation Instructions

1. On the Non-XR model, remove Front Fascia (A) after removing Bolts (B). See **Figure 1**.

*Note: The bumpers don't need to be removed on either the XR or Non-XR model, but can be removed if you find it easier for installation. We removed the bumper for clarity in photos.*

2. Install Tube Gusset (2) onto Winch Mount (1) as shown in **Figure 2**. The notches in each component will line up in the back. This hardware should be loose for installation.
3. Tube Gusset (2) will wrap behind Frame Bar (C), this will allow the 4 holes in the Winch Mount (1) to line up with Holes (D) in the frame. See **Figure 3** for clarity.
4. Angle the Winch Mount (1) as shown in **Figure 4**, so it can slip behind the bumper (not shown). Once it is hooked behind Frame Bar (C), allow it to swing down against the frame, as shown in **Figure 5**.

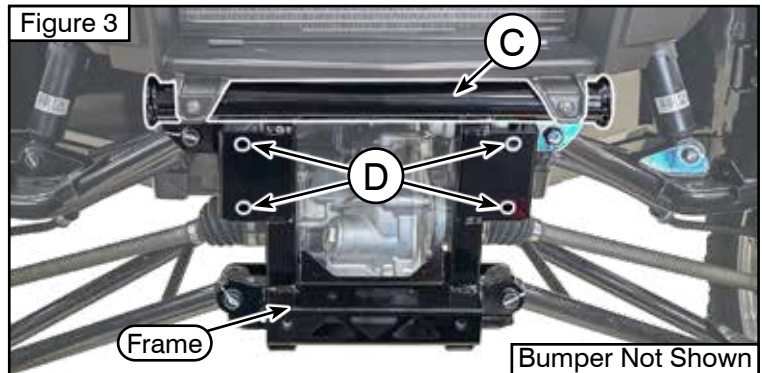
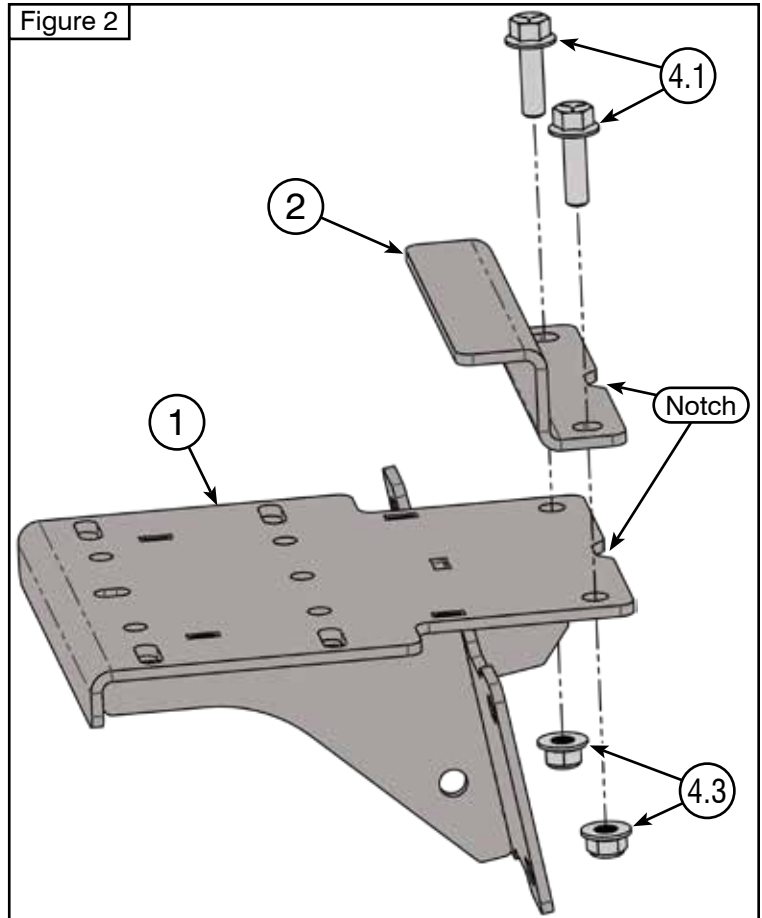

# INSTALLATION INSTRUCTIONS

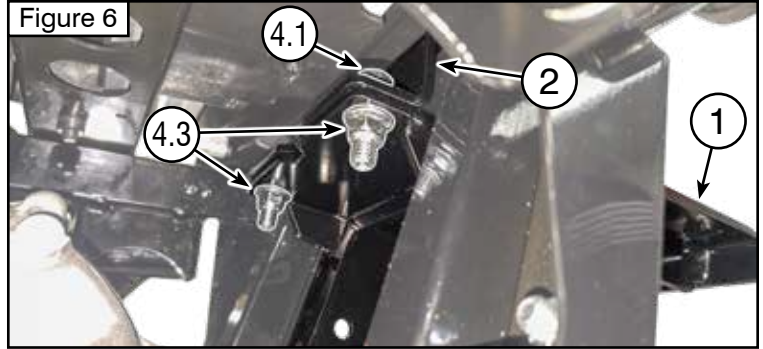
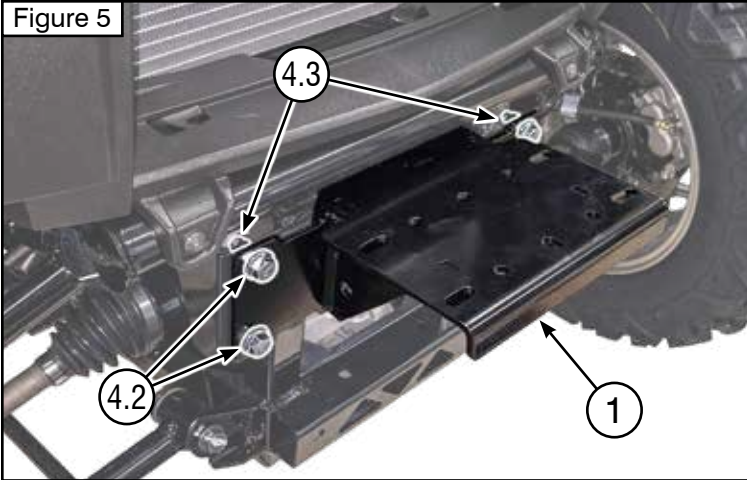

5. Install Bolts (4.2) through Winch Mount (1) and frame of the machine, securing with Nuts (4.3) on the back as shown in **Figure 5**.

6. Once all Winch Mount bolts are started, tighten them evenly. See **Figures 5 & 6**.

7. Use **Figure 7** to determine which holes to use when installing the winch.

- Holes (E) are designed for a wide winch. They are slotted so the winch can be slid one way or another to prevent interference. Make sure the wide winch is as close to center as possible.
- Holes (F) are used for a standard winch.
- Holes (G) are used with a 2-hole winch.

8. If this is installed on a Non-XR model, Install the Fairlead onto your Fairlead Bracket before installing the Winch. Use the winch manual for instruction. Skip this step on XR Machines.

9. Install the Winch onto the Winch Mount (1) and torque hardware according to your winch installation manual. See Notes Below:

- On XR models, install your winch on the winch mount without the Fairlead Bracket shown in **Figure 8**.
- On Non-XR Models, the Fairlead Bracket that came with your Winch will have to be installed at the same time as the Winch as shown in **Figure 8**.

10. On Non-XR Machines, reinstall Front Fascia (A) with Bolts (B) as shown in **Figure 1**. XR Models will skip this step.

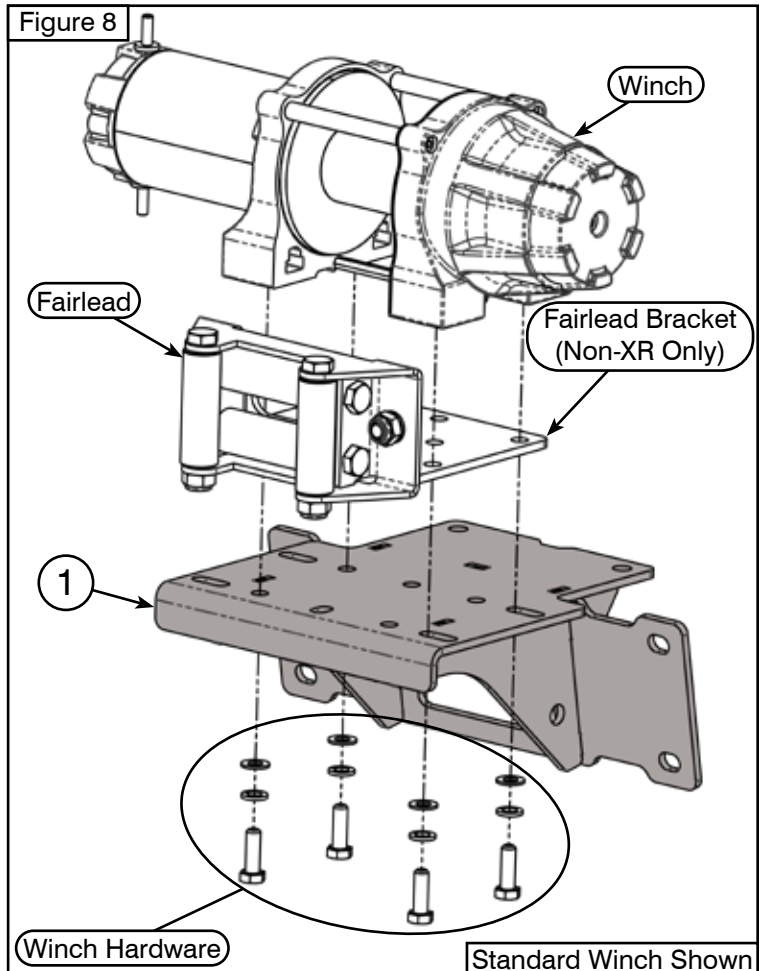
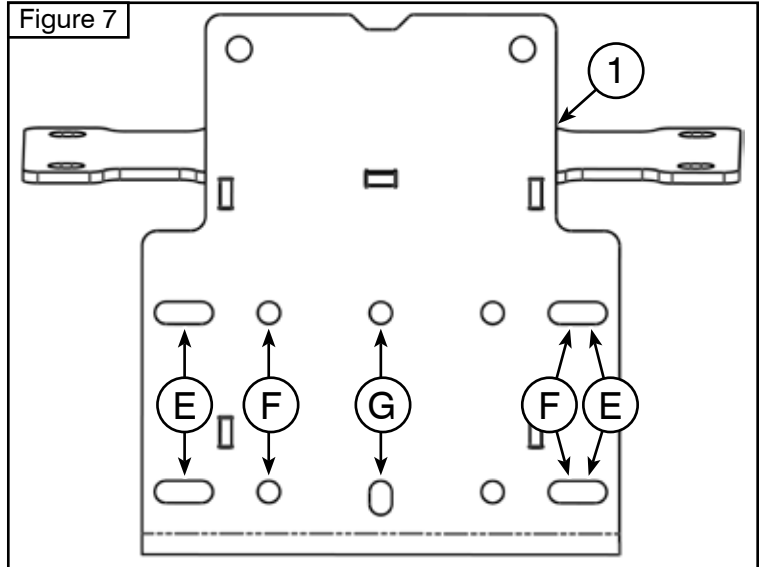

# INSTALLATION / WIRING INSTRUCTIONS

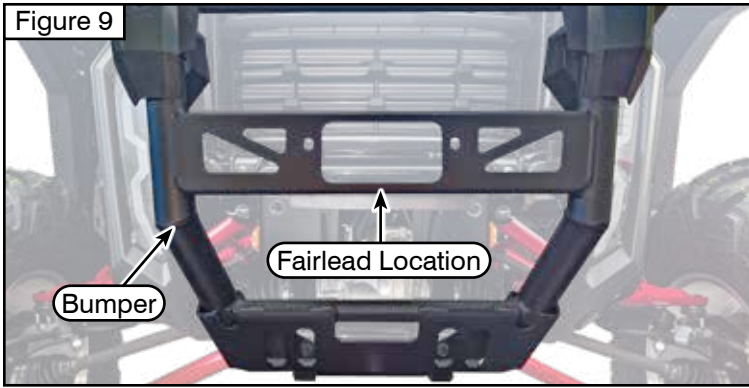

11. For the XR model, once you have the winch installed, you can install the Fairlead onto the bumper for your machine. If you have a wide winch, you can install directly to the Fairlead Location shown in **Figure 9**, using the hardware from your winch.

12. If you have a Standard Fairlead, you will have to use Adapter (3) as shown in **Figure 10**. Use the hardware that came with your winch with the addition of Bolt (5.1) and Nut (5.2)

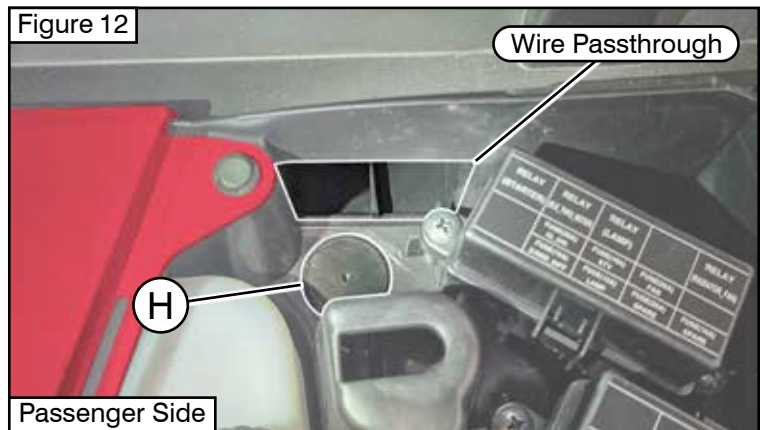
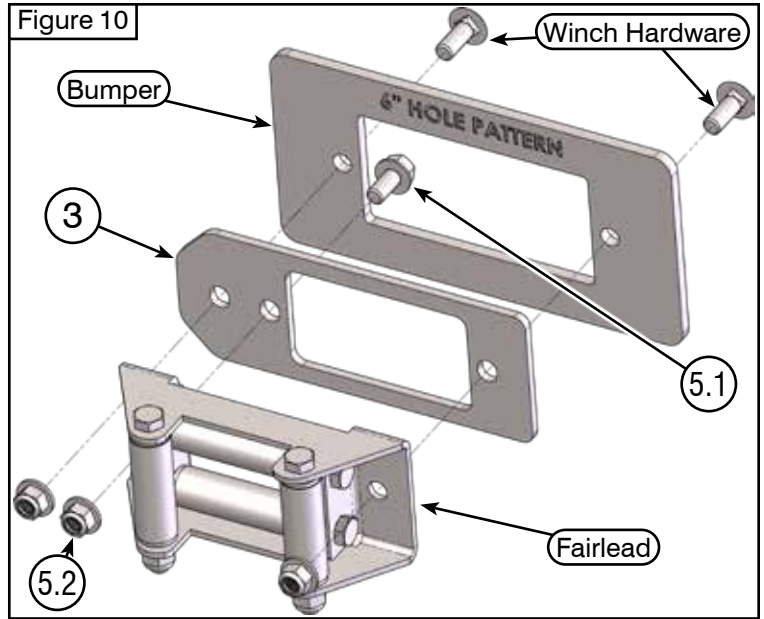

13. Depending on where you choose to install your contactor, reversing the winch power wires may be necessary. An Alternate Wiring Diagram can be found on **Page 6**.

14. The contactor for the winch can be installed under the hood of the machine to keep it out of the weather. A good location is the driver side of the hood compartment as shown in **Figure 11**.

15. Circle (H), on the passenger side of the hood compartment, marked in **Figure 12** can be drilled out so the power wires can be routed to the front distribution block shown in **Figure 13**, just behind the bumper.

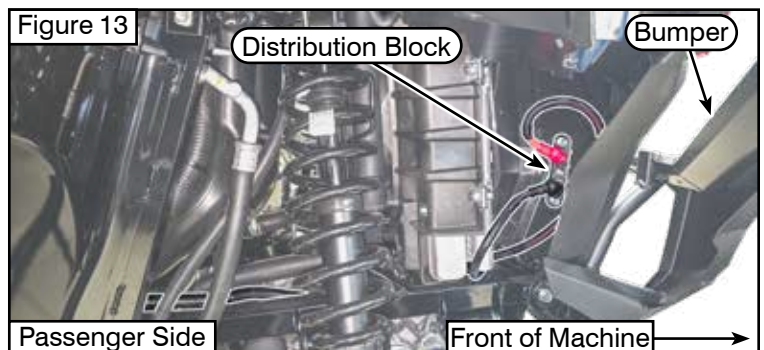

# WIRING INSTRUCTIONS

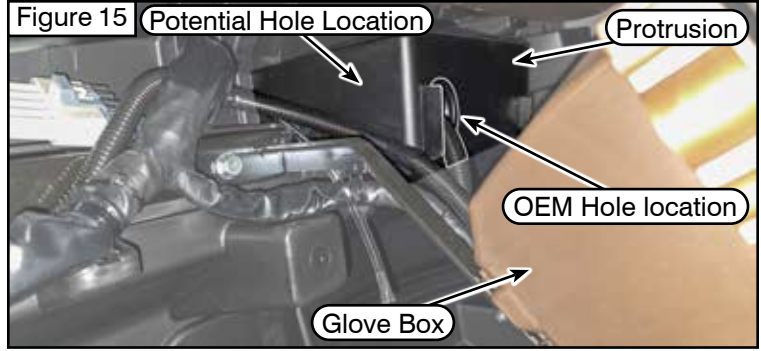

16. The center panel of the dash, shown in **Figure 14** can be removed for easier wiring. Gently pull around the panel to free the clips holding it in place.

17. There is a protrusion behind the glove box that will allow your winch switch wires to be fed through to the hood compartment where your contactor is located. If your machine doesn't already have the hole in this protrusion as shown in **Figure 15**, you can drill a hole through the side of the protrusion. Some machines may not have enough room to drill a hole in the side, and the glove box portion of the dash will need to be removed to drill out the OEM location.

18. If you need to remove the glove box section of the dash, remove the Screws (J) and the Plastic Rivets (K) shown in **Figure 16**. One Screw (J) is located inside of the glove box.

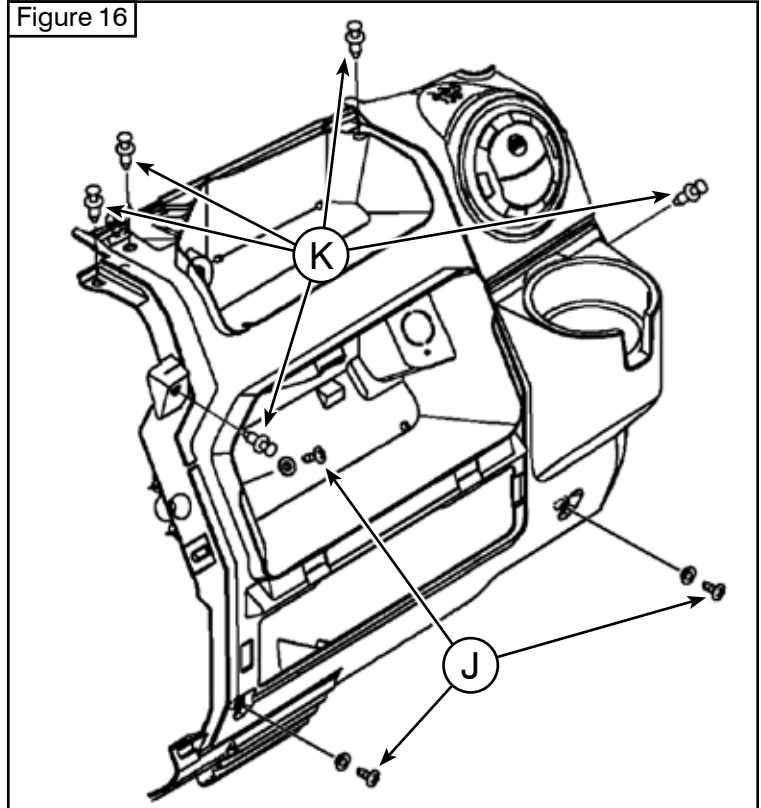

19. The rocker switch can be installed in the center panel of the dash shown in **Figure 14**. You will have to cut out one of the locations from the panel.

20. The Ignition controlled power for the winch switches can be connected to the distribution block, located under the glove box, behind a removable panel, on the passenger side of the machine. See **Figure 17**. You can cut a slit in the sheathing for the rocker switches so you can pull the red wire out where it's needed.

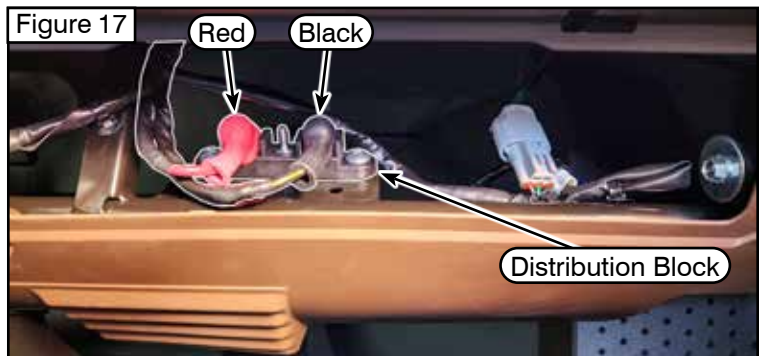

21. The outlet for the 14' corded hand remote (if applicable), can be installed in the glove box as shown in **Figure 18**.

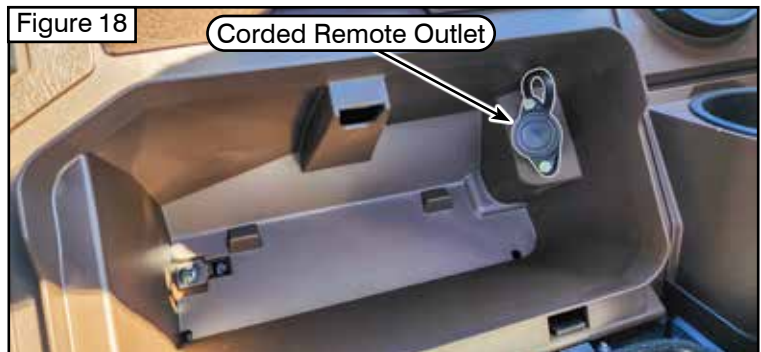

22. Ensure the dash is reinstalled using the appropriate hardware, using **Figures 14 & 16** for clarification.

# Alternate Wiring Diagram for KFI Winches

