

# CFMOTO ZFORCE 800 GEN 1

Plow Mount

PART #106600

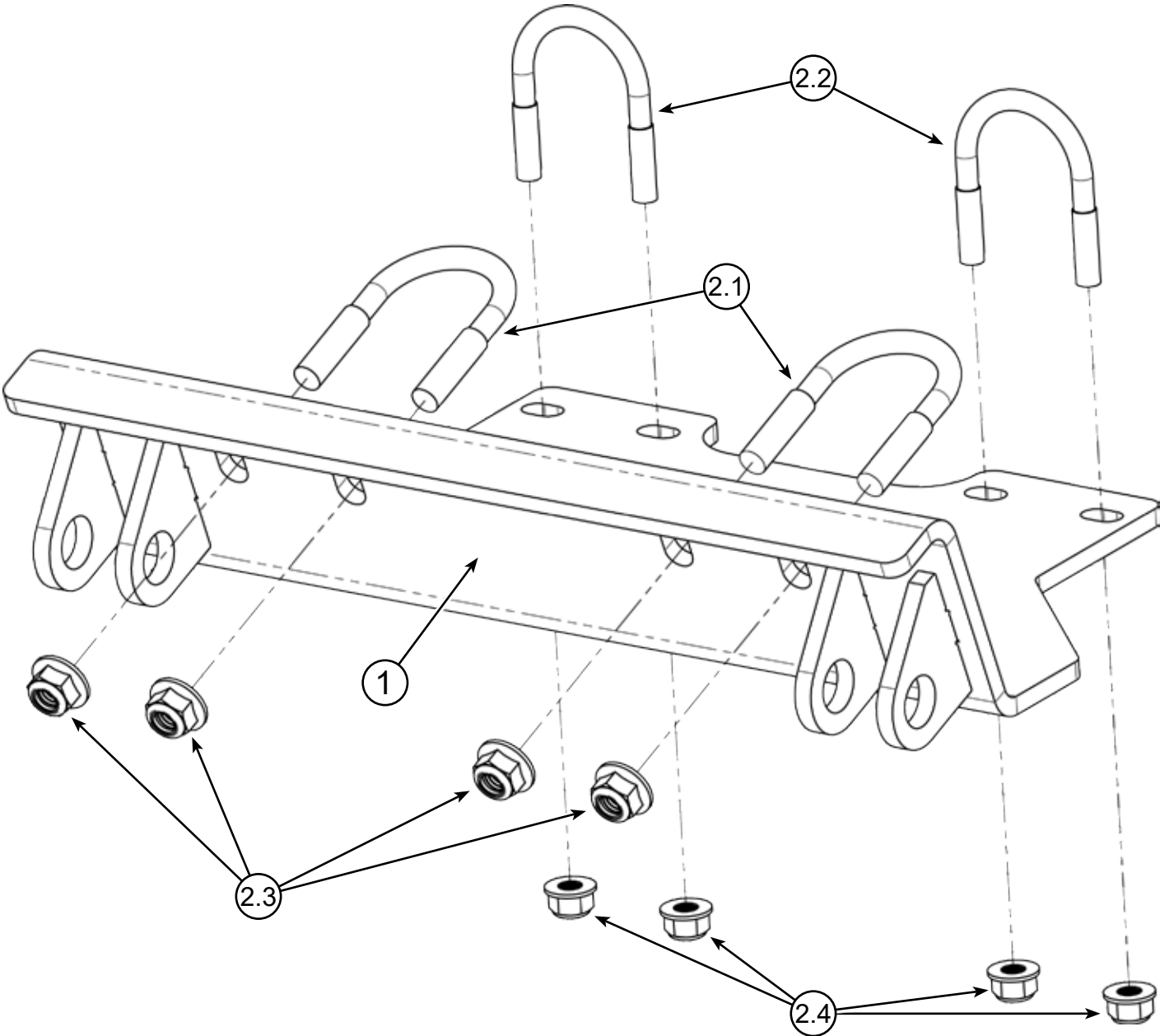

Kit Components:

Item #	Qty.	Description	Item #	Qty.	Description
1	1	Plow Mount	2.2	2	5/16-18 X 1½" X 2¾" X 1" Thread U-Bolt
2	1	Hardware Kit HK-438	2.3	4	3/8-16 Hex Nut Flange Nylock GR5
2.1	2	3/8-16 X 1½" X 2½" X 1¼" Thread U-Bolt	2.4	4	5/16-18 Hex Nut Flange Nylock GR5



# INSTALLATION INSTRUCTIONS

**Note:** Make sure all hardware needed to complete this mount is in the package. Thoroughly read through and understand the instructions before installing.

1. Remove the Lower Front Fascia (A) by removing the Plastic Retainer Clips (B) on each side of the fascia and the 4 Bolts (C) from the front. See **Figure 1**.
  2. Hold the Plow Mount (1) in place over the front, lower corner of the frame as shown in **Figure 2**, and install the larger, front U-Bolts (2.1). Loosely secure with Nuts (2.3).
  3. With the Plow Mount (1) held in place, use the plow mount as a template to mark the rear, inner u-bolt holes on the machine's skid plate.
  4. Remove the Plow Mount (1) so the rear holes can be drilled. Use at least a 7/16" drill bit. (Larger holes will not effect functionality, and can make installation easier) See **Figure 2**.
- ⚠ CAUTION** Be sure not to damage the front differential, which sits just above this location in the machine.
5. Once holes are drilled through the skid plate, install U-Bolts (2.1 & 2.2) around the frame and through the Plow Mount (1). Secure with Nuts (2.3 & 2.4) as shown in **Figures 2 & 3**.
  6. Tighten all hardware evenly.
  7. The Front Fascia (A) removed in **Step 1** can be modified for reinstallation as shown in **Figure 4**, or it can be omitted from the machine.
  8. To trim this plastic, hold the Fascia over its original location and mark the Fascia just above the top of the Plow Mount, then cut and reinstall as shown in **Figure 5**, using the original hardware.

