

# JOHN DEERE GATOR XUV 550

Plow Mount

PART #105455 Rev B

## Kit Components:

Item #	Qty.	Description
1	1	Plow Mount (106451)
2	1	Hardware Kit (HK-149)
2.1	4	1/2"-13 X 1.5" Hex Bolt Flange Serrated GR5
2.2	4	1/2"-13 Hex Nut Flange Nylock GR5

**Note:** Make sure all hardware needed to complete this mount is in the package. Thoroughly read through and understand the instructions before installing.

1. Remove bolts (A) on front lower panel as shown in **Figure 1**. Bumper will stay in place.
2. Place Plow Mount (1) over the lower front panel as shown in **Figure 2**. Use Bolts (2.1) and Nuts (2.2 Not Shown) to secure the Plow Mount (1) and Bumper.
3. Tighten all bolts evenly.
4. See UTV Push Tube Instruction Manual for Push Tube attachment.

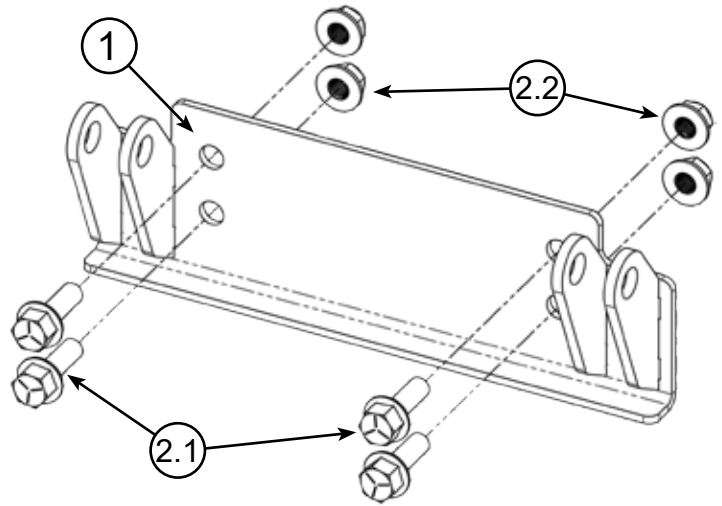

Figure 1

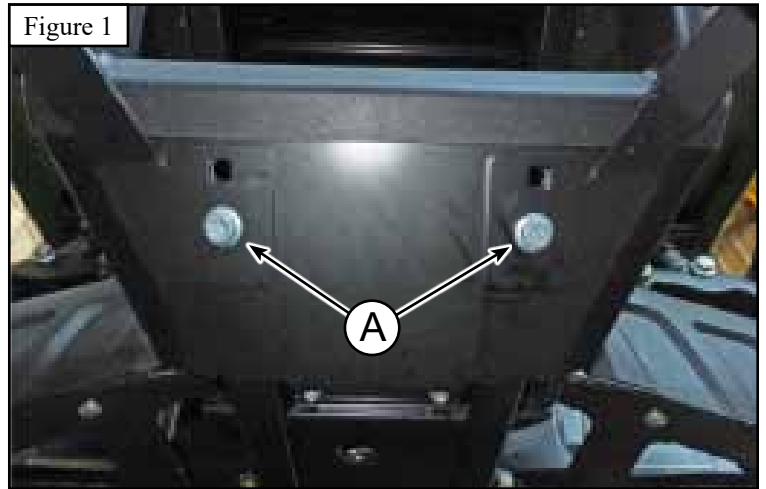

Figure 2

